

# VALEA

seating collection

---



**ICF**  
Office Furniture Made in Italy

ITALIAN QUALITY IN OFFICE FURNITURE



# ICF

## Office Furniture Made in Italy

---

Our chairs have always meant excellence for their aesthetics, functionality, quality of materials, solidity and comfort, and, above all, for the creative and manufacturing processes that are the basis of each collection. That special "Made in Italy" touch has made all our products special for over sixty years, because it is not simply fulfilling a need or providing a solution to a furnishing problem but they represent a real choice of style: ICF style. This is the reason why we are proud of them.

Da sempre le nostre sedute rappresentano un'eccellenza non solo per l'estetica, la funzionalità, la qualità dei materiali, la solidità, il comfort ma anche per tutti i processi creativi e produttivi alla base di ogni collezione. E' quel tocco di "Made in Italy" che rende in nostri prodotti speciali da oltre sessant'anni perché non si limitano a rispondere ad un'esigenza o a risolvere un problema d'arredo, ma rappresentano una vera e propria scelta di stile: lo stile ICF. Per questo ne siamo orgogliosi.

# The VALEA Collection



Comfort generates from elegance: this is the essence of the VALEA collection, a series of different sizes and models of armchairs to satisfy a range of needs.

The collection's distinctive feature is its curved, essential aluminium structure, the base of a completely padded seat covered in fabric or leather to "envelope" the user in comfort. An authentically relaxing chair.



Comfort sublimato dall'eleganza: è questa l'essenza della collezione VALEA, una serie di poltrone declinate in dimensioni e modelli differenti per soddisfare le più diverse esigenze.

Elemento distintivo della collezione è la struttura in alluminio, sinuosa ed essenziale, su cui poggia una seduta completamente imbottita e rivestita in tessuto o in pelle per "avvolgere" in tutta comodità chi la utilizza. Un vero e proprio invito al relax.

# Valea Elle

---

Solidity and expertise meet comfort and aesthetics. This is the beginning of VALEA ELLE, a chair with an essential but captivating line, designed mainly as the executive model of the Collection. In its simplicity, VALEA ELLE lends strength to the room where it is placed because of the details that highlight its line.

Solidità e autorevolezza incontrano comfort ed estetica. E' così che nasce VALEA ELLE, una seduta dalla linea essenziale, tuttavia estremamente accattivante nella forma, pensata soprattutto come modello executive della Collezione. Pur nella sua semplicità, VALEA ELLE caratterizza con forza lo spazio in cui viene inserita grazie a dettagli che ne enfatizzano la linea.







## Shape sublimated from colour

Essential lines are enhanced by a careful choice of colours for the upholstery, to convey warmth and energy to the office environment.

L'essenzialità della linea viene valorizzata da un'attenta ricerca cromatica nei rivestimenti per conferire calore ed energia allo spazio ufficio.







Available with high, low-height backrests or headrests, VALEA ELLE transmits an image of authority and pleasant warmth, giving the office environment a distinctive style. Stylistic details such as attention to finishes and variety of colours give the product a strong personality and a modern style.

Disponibile con schienale basso, alto o con poggiatesta, VALEA ELLE trasmette nel contempo un'immagine autorevole e di piacevole calore, conferendo uno stile distintivo all'ambiente ufficio. Dettagli stilistici come la cura delle finiture e la varietà nei colori le attribuiscono una personalità di forte tendenza.









Subtle and bold accents in the choice of colour combinations work harmoniously with the simplicity of the shapes.

Accenti più o meno audaci nella scelta dei cromatismi ben si armonizzano con forme caratterizzate dalla più assoluta semplicità.







**Tilting mechanism.** The tilting mechanism, intuitive and effective, follows the user's movements perfectly to guarantee maximum ergonomics.

**Armrests.** Die-cast aluminium armrests in different finishes, in addition to being comfortable, add character and personality to the chair.

**Seams and defined seams.** The seam is defined and detailed to emphasise the padded upholstery design, a distinctive element of the collection.

**Meccanismo di oscillazione.** Il meccanismo di oscillazione, intuitivo ed efficace, segue perfettamente i movimenti dell'utilizzatore, garantendo la massima ergonomia.

**Braccioni.** I braccioni in alluminio pressofuso in diverse finiture, oltre a essere comodi, aggiungono carattere e personalità alla poltrona.

**Cuciture e cuciture improntate.** Le improntature delle cuciture sono volutamente visibili e ben curate per evidenziare lo spessore dell'imbottitura, elemento distintivo della Collezione.

## State-of-the-art style and technology

Curved lines are reflected with expertise by the versatility of aluminium, which conveys a sense of strength and lightness at the same time. The broad and extremely comfortable seat is finished with elegance in every detail.

La sinuosità della linea viene interpretata magistralmente dalla versatilità dell'alluminio che comunica insieme vigore e leggerezza. La seduta ampia ed estremamente comoda è rifinita con eleganza nei minimi dettagli.





## Extremely versatile aesthetics

VALEA's versatile character is also expressed in its multiple finishes. In leather versions, VALEA manages to maintain the look of the Collection but conveys an image of greater prestige and authoritativeness.

La versatilità di VALEA si esprime anche nella molteplicità delle finiture possibili. Nella variante in pelle, pur mantenendo l'impronta della Collezione, VALEA comunica un'immagine di maggiore prestigio e autorevolezza.





# Valea Esse

---

VALEA ESSE has an even more contoured line that remains essential, modulated to create a lower back support that makes this version even more comfortable. Extreme comfort is guaranteed by the wide seat and its padding.

VALEA ESSE è caratterizzata da una linea ancor più sinuosa, ma pur sempre essenziale, modulata per creare un supporto lombare che rende questa versione ulteriormente confortevole. L'estrema comodità è garantita dalla seduta ampia e con una ricca imbottitura.





In any context where it is placed, VALEA ESSE has such a neat line that it adapts harmoniously to the space, while still adding a touch of very personal style.

Qualsiasi sia il contesto in cui viene inserita, VALEA ESSE ha una linea così pulita da adattarsi con armonia allo spazio, ma allo stesso tempo, aggiunge un tocco di stile molto personale.







In either leather or fabric finish, VALEA ESSE makes colour its main feature - conveying lightness and personality to the office environment.

Che sia nella finitura in pelle o in tessuto, VALEA ESSE rende il colore protagonista, conferendo brio e personalità all'ambiente ufficio.











**Armrests.** The shape of the armrests is original, but fluid and in complete harmony with the Valea Collection's underlying concept.

**Finishes.** Finishes made by precious materials are emphasized by details in the stitching, which becomes a main stylistic element.

**Comfort.** Technical aspects, such as the tilting mechanism, are indispensable complements for a style in which comfort plays such a big part.

**Braccioli.** La linea dei braccioli è originale, ma nel contempo fluida e in totale armonia concetto di base della Collezione Valea.

**Finiture.** La preziosità dei materiali nelle finiture è enfatizzata dai dettagli delle cuciture che diventano protagoniste di stile.

**Comfort.** Accorgimenti tecnici come il meccanismo di oscillazione sono indispensabili complementi di uno stile sviluppato all'insegna del comfort assoluto.

## Details of style and technology that make a difference

The style is emphasised even more by the dry essential structure, characterised by elegant, balanced proportions. The thickness of the seat stands out in the overall look of the chair, and strengthens the character of absolute comfort of the VALEA Collection.

Il gioco delle linee viene ancor più valorizzato dall'essenzialità asciutta della struttura, caratterizzata da proporzioni eleganti ed equilibrate. Lo spessore del sedile risalta nell'insieme ed enfatizza il carattere di assoluto comfort della Collezione VALEA.



A close-up photograph of a modern office chair. The chair features a tan leather finish with horizontal stitching on the backrest and seat. A polished chrome armrest is visible, curving downwards. The chair is set against a plain white background.

The leather finish sports unusual colours that soften the shapes of rigorous linearity.

La finitura in pelle si arricchisce di cromatismi inediti a sdrammatizzare forme di una rigorosa linearità.

# Valea Soft

---

The perfect blend of aesthetics and comfort of the VALEA Collection finds its highest expression in VALEA SOFT. This model has another detail that ensures comfort: a padded cushion for extra back support.

Il connubio perfetto tra estetica e comfort della Collezione VALEA trova la sua massima espressione in VALEA SOFT. Questo modello si arricchisce infatti di un ulteriore dettaglio all'insegna della comodità: un cuscino imbottito per sorreggere ancor più la schiena.





## Character in the details

In the SOFT version, VALEA's linearity appears even more accentuated to leave absolute space for comfort: the padded cushion covers the whole seat to make it the perfect place to relax.

Nella versione SOFT, la linearità di VALEA appare ancor più accentuata per lasciare spazio assoluto alla comodità: il cuscino imbottito copre tutta la seduta rendendola un vero e proprio invito al relax.











**Details.** The padding and width of the seat are so characteristic that they make Valea the perfect synonym for comfort and ergonomics, which are conveyed in every stylistic detail.

**Contrasts.** The flexibility of the armrest line is highlighted by the chrome finish on the aluminium to communicate the idea of dynamic movement and the captivating interplay of contrasts with the softness of the padding.

**Exclusiveness.** The attention to detail emphasizes the exclusive nature of the covers, whether they are in rigorous leather or more light-hearted fabric.

**Dettagli.** L'imbottitura e l'ampiezza della seduta sono talmente caratterizzanti da rendere Valea perfetto sinonimo di comfort ed ergonomia che traspaiono in ogni dettaglio stilistico.

**Contrasti.** La flessuosità della linea dei braccioli viene esaltata dalle cromature dell'alluminio a comunicare un'idea di dinamicità in un accattivante gioco di contrasti con la morbidezza delle imbottiture.

**Esclusività.** La cura dei dettagli enfatizza la preziosità dei rivestimenti, sia che si tratti del rigore della pelle che dell'allegria del tessuto.

## Technologically comfortable

The padding and width of the seat are so characteristic that they make VALEA the perfect synonym for comfort and ergonomics, which are conveyed in every stylistic detail.

L'imbottitura e l'ampiezza della seduta sono talmente caratterizzanti da rendere VALEA perfetto sinonimo di comfort ed ergonomia che traspaiono in ogni dettaglio stilistico.



Vitality, comfort, lightness: VALEA SOFT has been invented to offer high level solutions in every detail.

Brio, comodità, leggerezza: VALEA SOFT è stata pensata per offrire soluzioni ai massimi livelli in ogni dettaglio.







Brighter colours match perfectly with the neat lines and innovative interplay of contrasts.

I cromatismi più accesi si sposano alla perfezione con la pulizia della linea in un inedito gioco di contrasti.





# Valea Cantilever

---

The unique comfort and aesthetics of VALEA are enhanced by a traditional element: the cantilever base, a classic in the world of office chairs. The result is the new model VALEA CANTILEVER, which reflects the decisive personality of the VALEA collection with new intensity. Hints of classic design blend with functional, modern solutions to form a chair that is not only comfortable, but also particularly versatile and suitable for both operative areas and waiting or meeting rooms.

Il comfort e l'estetica unici di VALEA si arricchiscono di un elemento della tradizione: il basamento a "slitta", un classico delle sedute da ufficio. Il risultato è il nuovo modello VALEA CANTILEVER, in cui la già decisa personalità della collezione VALEA ne risulta ancor più enfatizzata. Accenni al design più classico si fondono con soluzioni funzionali e di estrema attualità per una sedia non solo comoda, ma anche particolarmente versatile, adatta sia ad ambienti operativi sia a zone attese o riunioni.







## Lightness and versatility for a classic design

The structure is so light and clean that it seems to float in the air. The cantilever base with its extreme linearity emphasises the shape of the chair and makes it perfect for any place in the room.

Una struttura così pulita e leggera da sembrare fluttuare nello spazio. Il basamento a slitta, nella sua estrema linearità, enfatizza la forma della seduta e la rende perfetta per qualsiasi collocazione.





# Valea Lounge

---

VALEA LOUNGE was created to perform its function with style and comfort. Destined mainly for waiting rooms or meeting rooms, it keeps all the characteristics of the models with taller backrests and becomes a harmonious addition to any common area. This is the strong point of the VALEA Collection: great versatility that never weakens the line's original personality.

VALEA LOUNGE nasce per accogliere con stile e comfort. Destinata prevalentemente a zone attesa o sale riunioni, mantiene tutte le caratteristiche dei modelli con schienali più alti inserendosi con grazia e armonia negli spazi comuni. E' questa la forza della Collezione VALEA: una grande versatilità che tuttavia non ne impoverisce il carattere originario.





## Waiting is a pleasure

Essential line and maximum comfort: the chair's wide seat is defined with absolute simplicity and gains impact and personality through its generous padding. Its stylistic details make it the real protagonist of this chair.

Linea essenziale e massimo comfort: la seduta ampia e definita dalla semplicità assoluta di forme, acquista spessore e personalità grazie alla ricca imbottitura, resa ancor più protagonista dai dettagli stilistici.







## Design that invites to relax

Each individual detail of VALEA LOUNGE has been fine-tuned to achieve a unique level of comfort: seat dimensions, choice of padding, and technical aspects all guarantee top-level ergonomics and comfort.

Ogni minimo particolare di VALEA LOUNGE è stato studiato per contribuire al comfort unico della seduta: dalle dimensioni del sedile, alla scelta dell'imbottitura agli accorgimenti tecnici che garantiscono il massimo dell'ergonomia e della comodità.





## Waiting becomes exciting

In line with the latest fashion trends, the leather and fabric covers of this Collection are available in a wide range of colours: bold, neutral, or delicate palette will warm and brighten the room.

In linea con le ultime tendenze moda, i rivestimenti della Collezione sono disponibili in un'ampia gamma di colori, sia nella variante pelle che tessuto: cromatismi più o meno accesi che scaldano e rallegrano lo spazio.





# TECHNICAL Features



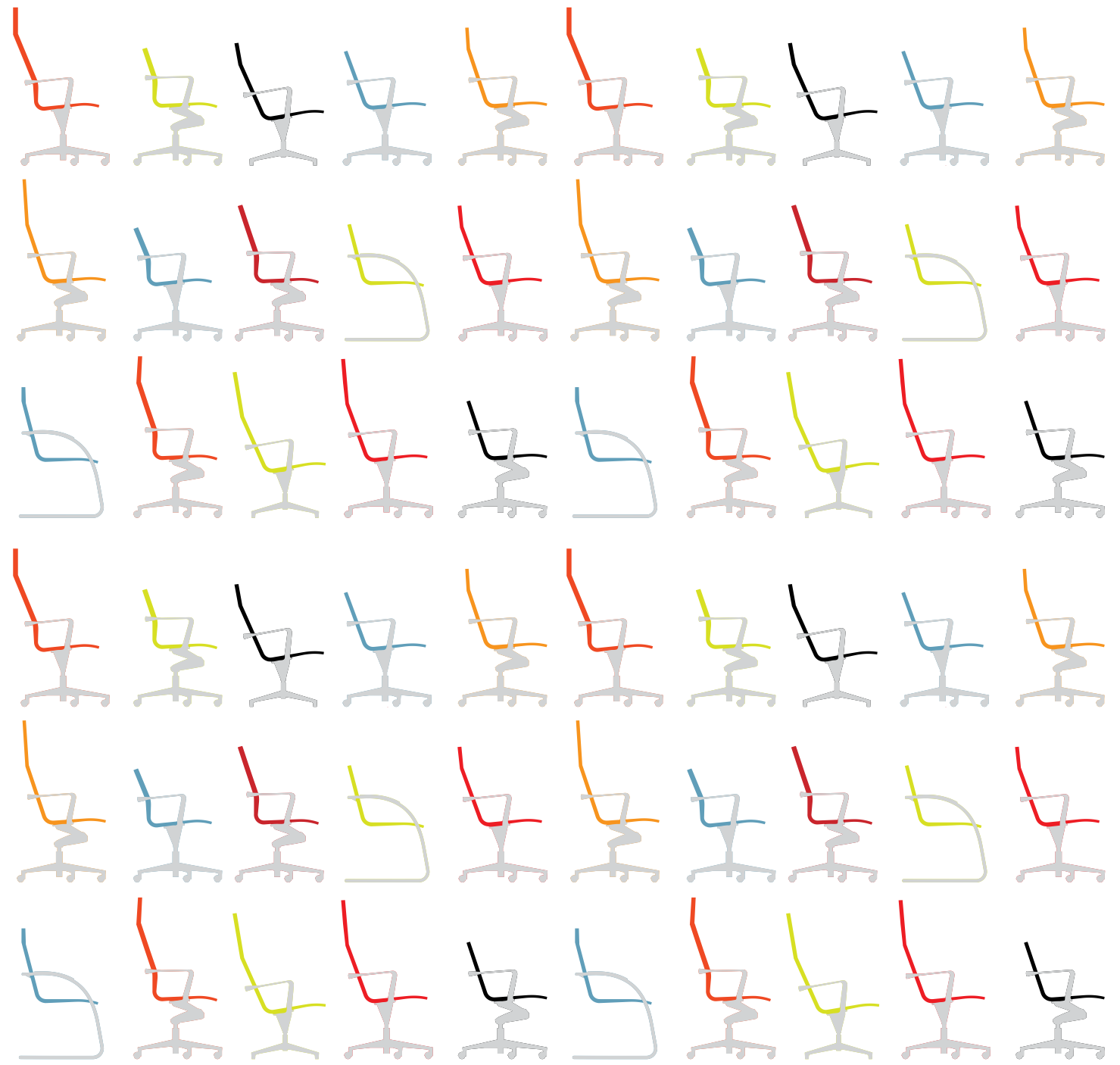

# Performing technology

VALEA chairs are designed to provide maximum comfort. Exceptional attention has been paid not only to ergonomic aspects but also to the idea and development of every detail involved in form and function. VALEA chair offers a series of mechanical devices that improve comfort when you are seated even for a significant number of hours. Since the height of the seat can be adjusted as desired, the body assumes the correct position. VALEA chair can be equipped with a mechanism that returns the seat to its original position, so that the office always presents an orderly image.

## Tilting Mechanism

Valea Chair has a simple, very effective tilting mechanism that promotes movement and provides a high level of comfort, reducing stress and strains. The rearward seat tilting mechanism pivots from the front of the chair, so that the angle is downward motion, relieving leg stress points and allowing stability in foot positioning on the rearward tilt. The tilting system has an adjustable tension control according to the user's weight and is lockable in various positions.



## Base

The 4 and 5 star base are made of die-cast aluminum available in polished and chromed finishing. The ICF custom base design is balanced well with the overall product design and gives particular attention to details.

### Padding / fabric or leather

The leather or fabric upholstery is welded onto flexible polyurethane. The sheet thus obtained has a series of typical horizontal stripes and fits to perfectly distribute the weight of the body.

### Armrests

They have a closed shape and are made of die cast aluminum available in polished or chromed finishing.

### Auto-return mechanism

The 4 star base has a special column that allows free-swiveling in use and that automatically rotates backrest to a frontward facing position. The fixed height column helps to keep your meeting room always in an ordinate manner.



### Castors

Standard: body made of reinforced copolymer with chromed die-cast, zamak hood; twin-wheels reinforced copolymer soft treads, suitable for all floors.

### Height adjustment

The 5 star base model has a height adjustment column that allows to adjust the chair individually according to different heights of users and sitting habits. The heights adjustment column allows height regulation in any position along the total stroke through internal movement of gas. It is controlled by pulling up a simple, well visible and intuitive lever.

### Glides

Standard black nylon base, white soft central elements, suitable for all floors.

# Configurations

VALEA offers the widest range of choice and is available in three backrest heights. Options are autoreturn mechanism, height adjustment and tilting mechanism with enhanced forward rotation.

There are two different bases: 4 star base on glides or 5 star base on castors.

There are also versions with "ELLE" and "ESSE" back and "LOUNGE" with a wider seat.

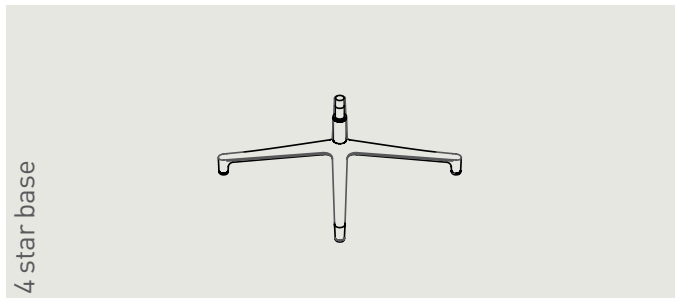
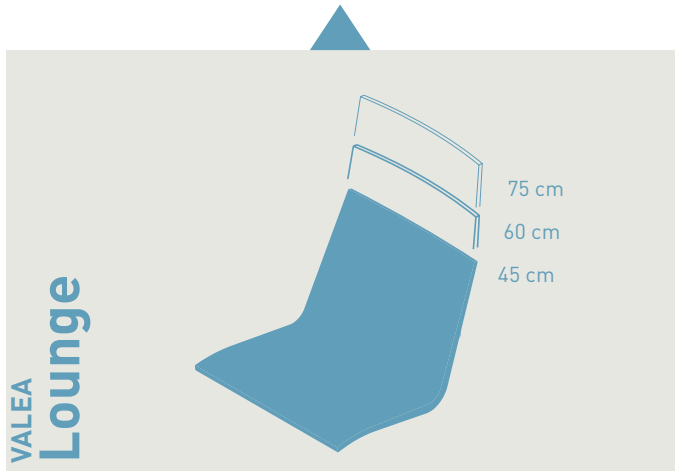
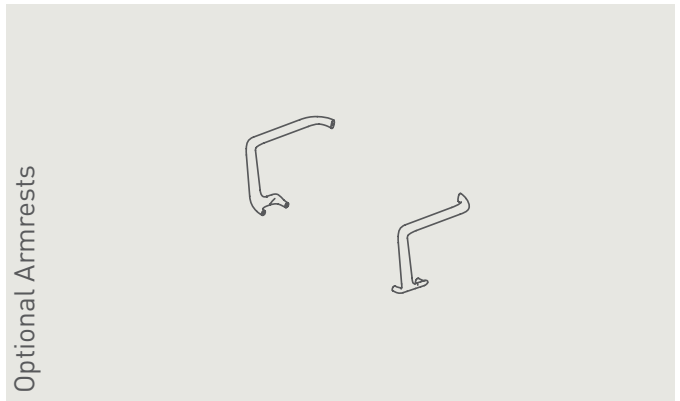

Optional Armrests

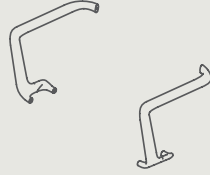

VALEA  
**Elle**

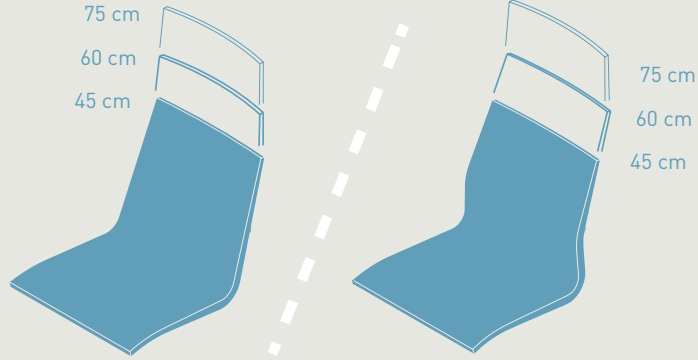

VALEA  
**Esse**

Fixed Height  
Support



Adjustable Height  
Support

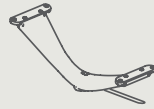

Tilting  
Support

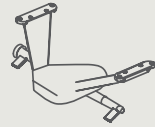

4 star base

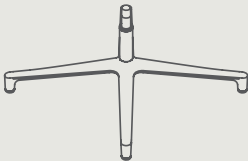

5 star base on castors

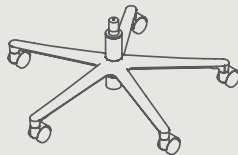

5 star base on castors

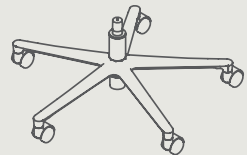



# Finishings



At ICF we have very carefully selected the best fabrics, the most resistant techno materials and the most valuable leather, which make up the integral and weight bearing part of our chair's structure. We offer different finishes that are always updated according to the latest trends and give a touch of colour and originality to the environment where they are placed.

**CAT B** Atlantic

**CAT C** Fame  
Step  
Step Melange  
Sotega

**CAT F** Breeze  
Fame Hybrid

**CAT E** Leather

**CAT H** (only Soft) Premium Leather

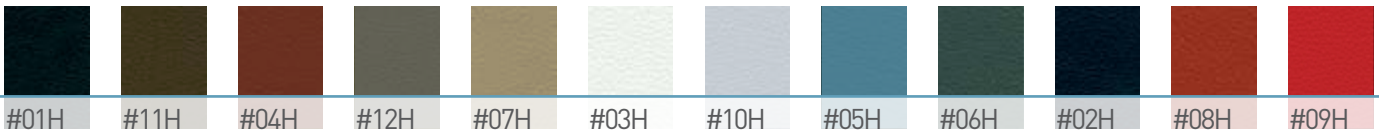
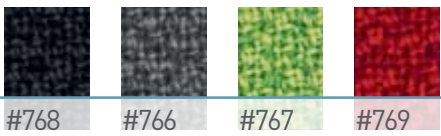
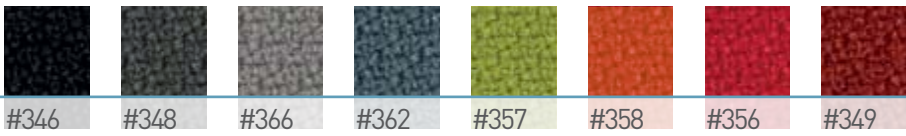
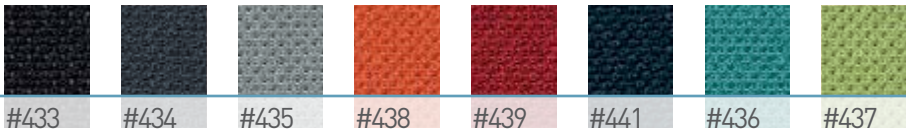

Surfaces & Metals

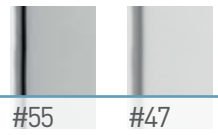

# Dimensions

## Fixed Height Support

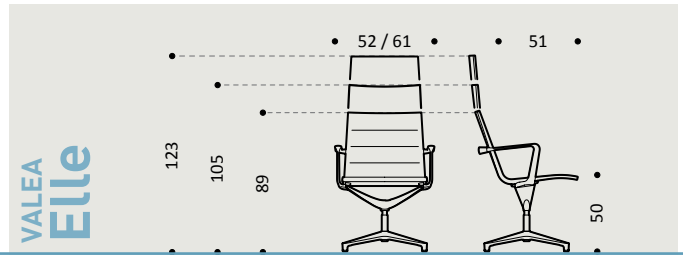

## Adjustable Height Support

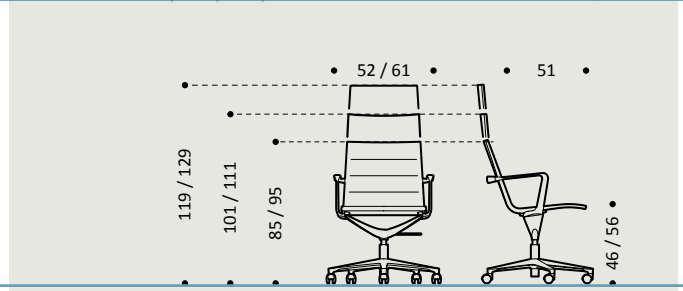

## Tilting Support

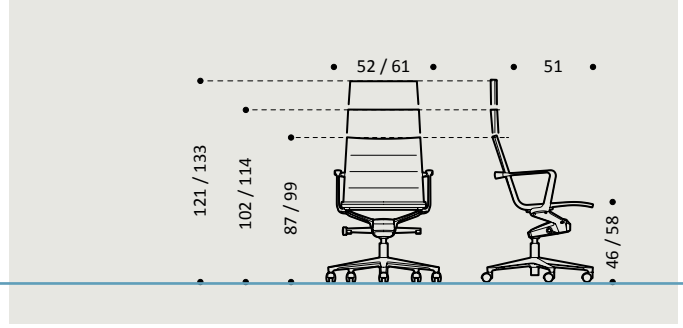

To meet the demands of an increasingly competitive market, we submit our products to rigorous tests that certify dimension, safety, solidity and resistance that define internationally accepted comfort and quality standards.

## Fixed Height Support

## Cantilever Support

VALEA  
Esse

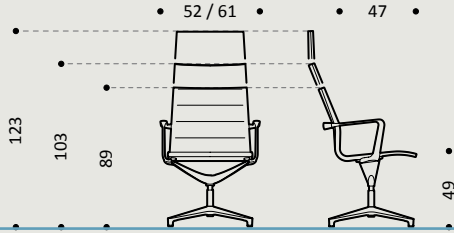

VALEA  
Soft

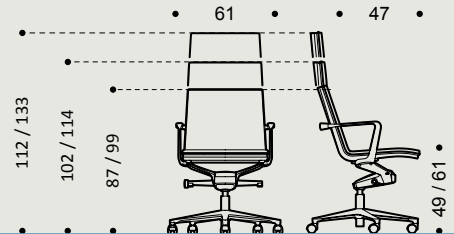
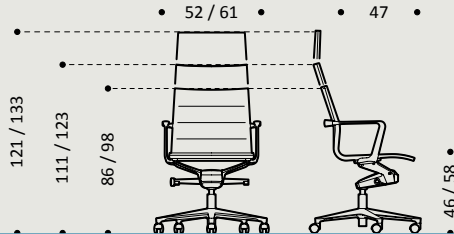
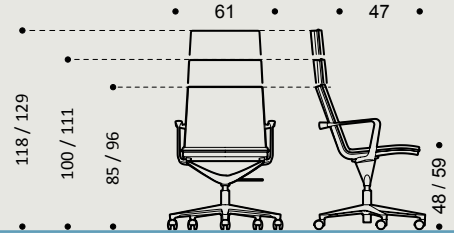
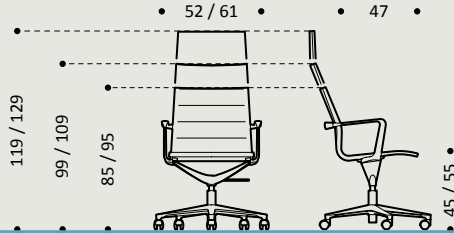
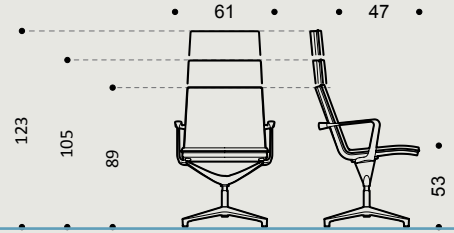

VALEA  
Lounge

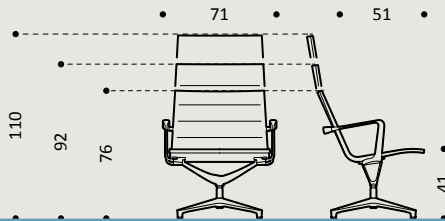

VALEA  
Lounge  
Soft

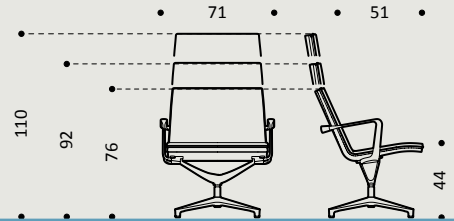

VALEA  
Cantilever

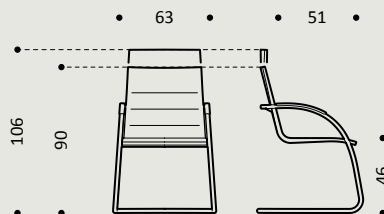

VALEA  
Cantilever  
Soft

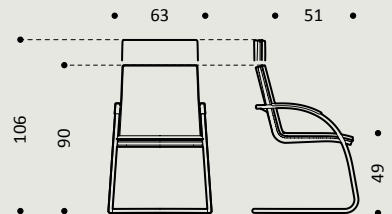





**ICF S.p.A.**  
Via Cassanese, 108  
20060 Vignate (MI), Italy  
t. +39 02 9508031 f. +39 02 95364012  
icf@icf-office.it www.icf-office.it

